

Autokeeper®

Safety Pen Needle

INSTRUCTION FOR USE

IFU-SPN-01(Rev.7 / 2025. 05)

Autokeeper® Safety Pen Needle Model :

- Autokeeper® Safety Pen Needle 29G X 4mm, 5mm, 6mm, 8mm
- Autokeeper® Safety Pen Needle 30G X 4mm, 5mm, 6mm, 8mm
- Autokeeper® Safety Pen Needle 31G X 4mm, 5mm, 6mm, 8mm
- Autokeeper® Safety Pen Needle 32G X 4mm, 5mm, 6mm, 8mm
- Autokeeper® Safety Pen Needle 33G X 4mm, 5mm, 6mm, 8mm
- Autokeeper® Safety Pen Needle 34G X 4mm, 5mm, 6mm, 8mm

Introduction

- Before using Autokeeper® Safety Pen Needle please read these instructions carefully.
- Autokeeper® Safety Pen Needle is a sterile single-use pen needle with a safety mechanism that automatically activates after the injection process.
- The safety shield indicates that the safety pen needle has been used.
- If the safety shield is not visible, the safety pen needle cannot be used.
- It shall be used by healthcare professionals, caretakers and patients**

MedExel

1 Components

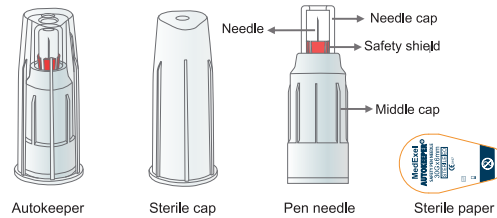

2 Intended Use

Autokeeper® Safety Pen Needle is intended for use with insulin pens for subcutaneous injection of insulin. The attached safety shield automatically locks in place and avoids cross infection caused by accidental puncture injuries from the patient's end of the cannula.

3 Usage Method

- Clean the rubber seal on the pen with an alcohol swab.
- Take the sterile paper off from the AutoKeeper®.

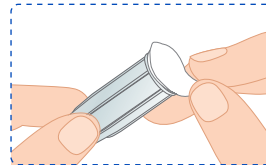

- Holding the sterile cap, push and twist the pen needle straight onto the pen in a clockwise direction until it meets resistance with crunching sound.

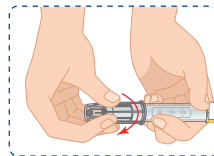

- Remove the sterile cap from pen needle

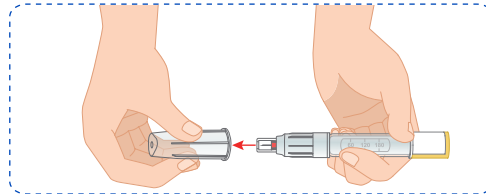

- Check cannula to see if it's damaged (bent, broken, etc.). Venting the pen: Set 1-2 insulin units and allow 1-2 drops to flow out of the pen needle.

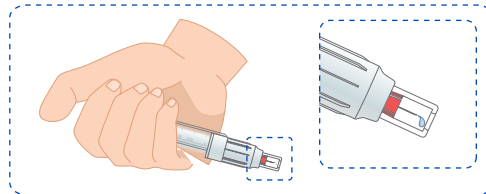

- Dial the prescribed dosage on the pen.

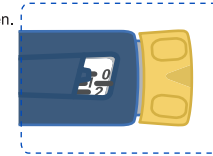

- Pull the skin tight and insert the pen needle straight into the skin at an angle of 90° until the middle cap touches the skin and the "click" sound is audible. For 8mm, pinch the skin up to 1" to avoid an intramuscular injection



- Inject insulin according to instructions for use of the insulin pen. Leave the insulin pen in the skin for 10 seconds after injection.

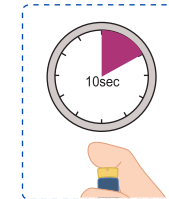

- Remove safety pen needle from the skin. The safety mechanism is released automatically.

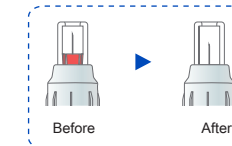

- After injection Twist the insulin pen counterclockwise to remove the pen needle from the pen.

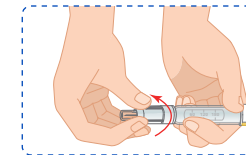

4 Warning

- Do not use the safety pen needle if:
 - the sterile cap or sterile paper is damaged,
 - the sterile paper is detached,
 - the cannula is bent or damaged.
- Do not use the pen needle if the shelf life is exceeded.

5 Caution

- Before using the insulin pen, consult its instructions for use.
- Always perform the injection at a 90° angle to the skin. Do not change the angle in order to prevent bending or breaking of the pen needle.
- Only use compatible pens with Autokeeper® Safety Pen Needle.
- Before use, take care not to activate the safety mechanism accidentally, as the safety pen needle cannot be used anymore.
- Store the pen needles in a dry place at 1°C up to 30°C

Compatible Pens

If your insulin pen is not listed, please contact us to check compatibility.

The insulin pens listed in the IFU may have different external features but they have the same joints as the pens that are tested in the compatibility test. Therefore the results of the test cover the entire pen described in the IFU.

- Humapen Savvio ■ Humatropen ■ Humapen Luxura
- Humalog Mix25tm ■ HumulinPen ■ NovoPen 3
- NovoPen 4 ■ NovoPen 5 ■ Novo Echo ■ NovoPen Junior
- NovoLet N ■ NovoMix 30 FlexPen ■ Induo ■ Lantus
- Solostar Pen ■ AllsterPro ■ Sanofi Optiset ■ Core Tropin
- JuniorStar ■ Owen Autopen ■ BD Pen ■ Wangbang ■ Delfu

EXPLANATION OF SYMBOLS	
	Catalogue number
	Manufacturer
	Date of manufacture
	Authorized representative in the European Community
	Consult instructions for use
	Use-by date
	Lot number
	Caution
	Keep dry
	Do not reuse
	Do not use if the product sterile barrier system or its packaging is compromised.
	Do not resterilize
	Temperature limit
	Sterilized using ethylene oxide
	CE Mark of Conformity with NB identification Number (NB 0197)
	Medical Device
	Unique Device Identifier

Medexel Co., Ltd.
 252, Geumgwangosan-ro,
 Geumgwang-myeon,
 Anseong-si, Gyeonggi-do,
 KOREA
 Tel: +82-31-299-1077
 Fax: +82-31-677-8087
 www.medexel.co.kr

Medical Technology Promet
 Consulting GmbH Ernst-
 Hechel-Straße 7, 66386 St.
 Ingbert, Germany