

297mm x 210mm

**UltiCare**

Safety Pen Needles

**Instructions for Use**

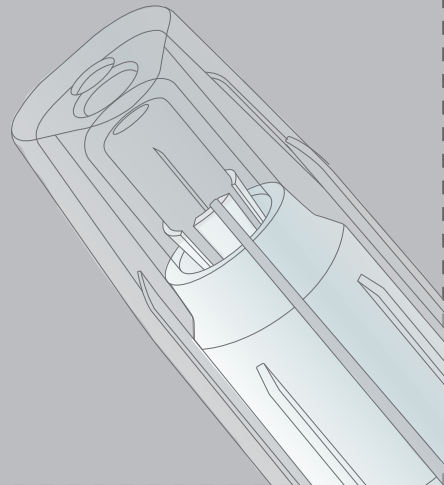

**1 Components**

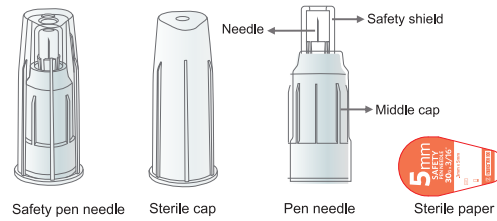

**2 Intended Use**

UltiCare Safety Pen Needle is intended for use with insulin pens for subcutaneous injection of insulin. The attached safety shield automatically locks in place and avoids cross infection caused by accidental puncture injuries from the patient's end of the cannula.

**3 How to Attach Needle to Insulin Pen**

- ① Clean the rubber seal on the pen with an alcohol swab.
- ② Remove the paper tab.

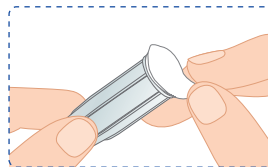

- ③ Holding the sterile cap, push and twist the pen needle straight onto the pen in a clockwise direction until it meets resistance.

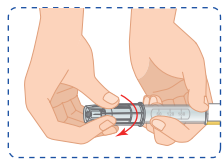

- ④ Remove the sterile cap from pen needle.

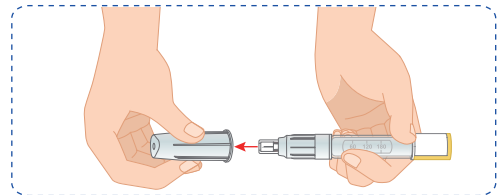

- ⑤ Check needle to see if it's damaged (bent, broken, etc.). Priming the pen: Set 1-2 insulin units and allow 1-2 drops to flow out of the pen needle.

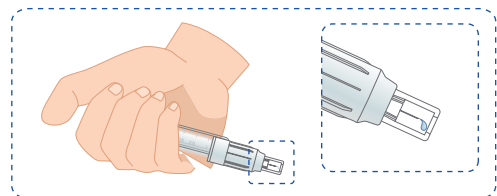

- ⑥ Dial the prescribed dosage on the pen.

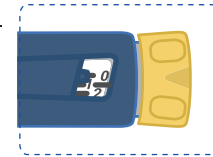

- ⑦ Pull the skin tight and insert the pen needle straight into the skin to activate the safety mechanism and the audible "click" is heard. For the 8mm pinch the skin up 1" to avoid an intramuscular injection.

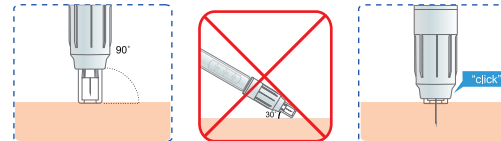

- ⑧ Inject insulin according to instructions for use of the insulin pen. Leave the insulin pen in the skin for 10 seconds after injection.

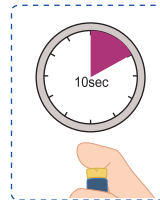

- ⑨ Once the entire dose has been given, lift the pen away from the skin. The safety shield will now be locked.

- ⑩ After injection, twist the insulin pen counterclockwise to remove the pen needle from the pen. Discard the used pen needle into an approved medical waste sharps container.

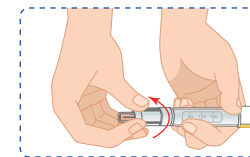

**4 Warning**

- ① Do not use the pen needle if:
  - the sterile cap or sterile paper is damaged,
  - the sterile paper is detached,
  - the needle is bent or damaged.
- ② Do not use the pen needle after the expiration date on the package.
- ③ Use each pen needle only once.

**5 Caution**

- ① Before using the insulin pen, consult its instructions for use.
- ② Consult your physician before changing pen needle lengths.
- ③ If medication drips from the pen needle, pen, or injection site, follow your physician's instructions regarding the handling of a potential under-dosage.
- ④ Before use, take care not to activate the safety mechanism accidentally, as the safety pen needle cannot be used anymore.

**Universal Fit:**

Compatible with most diabetes pen injector devices. A list of compatible pens is as follows:

The insulin pens listed in this IFU may have different external features but they have the same joints as the pens that are tested in the compatibility test. Therefore the results of the test cover the entire pen described in the IFU.

- HumaPen Savvio ■ Humatropen ■ HumaPen Luxura
- Humalog Mix25tm ■ Humulin Pen ■ NovoPen 3
- NovoPen 4 ■ NovoPen 5 ■ Novo Echo ■ NovoPen Junior
- NovoLet N ■ NovoMix 30 ■ Induo ■ Lantus Solostar Pen
- AllsterPro ■ Sanofi Optiset ■ Core Tropin
- JuniorStar ■ Owen Autopen ■ BD Pen ■ Wangbang ■ Delfu

**Introduction**

- Before using UltiCare Safety Pen Needle please read these instructions carefully.
- UltiCare Safety Pen Needle is a sterile single-use pen needle with a safety mechanism that automatically activates after the injection process.
- It shall be used by health care professionals, caretakers and patients

EXPLANATION OF SYMBOLS	
	Consult instructions for use
	Use-by date
	Lot number
	Caution
	Keep dry
	Do not reuse
	Do not use if the product sterile barrier system or its packaging is compromised.
	Do not resterilize
	Sterilized using ethylene oxide
	Authorized representative in the European Community
	Manufacturer
	Date of manufacture
	Unique device identifier
	Medical Device
	Catalogue number
	Temperature limit
	CE Mark of Conformity with NB Identification Number (NB 0197)

Satisfaction guaranteed or your money back.  
 Call 1-877-854-3434 Toll Free M-F 8am-4pm CST or visit our website at [www.ulticare.com](http://www.ulticare.com).  
 Distributed by: UltiMed, Inc. Excelsior, MN 55331

Medexel Co., Ltd.  
 252, Geumgwangosan-ro,  
 Geumwang-myeon, Anseong-si,  
 Gyeonggi-do, KOREA  
 Tel: +82-31-299-1077  
 Fax: +82-31-677-8087  
 www.medexel.co.kr

Medical Technology Promet  
 Consulting GmbH  
 Ernst-Heckel-Straße 7, 66386 St.  
 Ingbert, Germany